

DISCLAIMER:
The information contained in this brochure is provided as is and without any warranties of any kind, whether expressed or implied, including but not limited to, implied warranties of satisfactory quality, fitness for a particular purpose and/or correctness. The contents of this brochure is for general information purposes only and does not constitute advice.
Fiat Chrysler Automobiles South Africa (Pty) Ltd does not represent or warrant that the information and/or specifications contained in this brochure are accurate, complete or current and specifically stipulate that certain vehicle details and specifications contained in this brochure may differ in available models. Therefore, Fiat Chrysler Automobiles South Africa (Pty) Ltd makes no warranties or representations regarding the use of the content, details, specifications or information contained in this brochure in terms of their correctness, accuracy, adequacy, usefulness, timeliness, reliability or otherwise, in each case to the fullest extent permitted by law.

October 2018 • Part number: 59033154



www.fiat.co.za





EVEN MORE 500 EVEN MORE ICONIC.



True legends don't grow old: they change. Just like Fiat 500, the icon of Italian design and lifestyle, which has been reinventing and renewing itself for almost 60 years while remaining faithful to its original spirit. Hip and cool ever since it first took to the road, today the **New Fiat 500** is born again with an even bolder and captivating personality, greeting the world with a fabulous new look: an irresistibly cheeky charm guaranteed to turn heads.

POP



The version that welcomes you into the 500 world. The **New Fiat 500 POP** is the car with a “casual” style, ideally suited to every day life.



POP • 7 airbags • LED daytime running lights • 14” steel wheel covers • Chrome door handles • Height-adjustable steering wheel • Uconnect™ Radio with USB and Aux-in and steering wheel mounted audio controls • Electric front windows • Speed Limiter.

POP STAR



The **New Fiat 500 POP STAR** is a step up from the basic version with unexpected features that get heads turning.



POP STAR + in addition to POP • Front foglights • Rear parking sensors • Leather steering wheel • Electric rearview mirror • 15” alloy wheels • Uconnect™ 5” radio

LOUNGE



Elegant at a first glance and so chic at the same time, the **New Fiat 500 LOUNGE** is like a classic suit redesigned with a contemporary twist, that stands out for its refined details.



LOUNGE + in addition to POP • Panoramic roof • Uconnect™ 7" Touch screen Radio Live • Apple CarPlay integration • Android Auto compatibility
• 16" alloy wheels • Leather steering wheel • Chrome front grille • New poly-elliptic headlights • Cruise Control • Auto Climate Control • Body coloured mirror covers.

500S



She is highly capable of capturing the attention of whoever walks by. That is because she can flaunt two exclusive colours, **Blue Italia** and the new **Matt Alpi Green**, perfect to highlight its sporty nature.



500S • Sporty front and rear bumpers • Details such as Satin Graphite finished door handles and side mirror covers • Fog lamps • Privacy glasses
• Chromed exhaust pipe • 15" alloy wheels with the new Satin Graphite finish or 16" alloy wheels, including the new matt black with diamond finish
• Uconnect™ 7" Radio HD & Uconnect™ link: Apple CarPlay integration & Android Auto compatibility.



I'M SOCIAL.

BUT NOT
A FOLLOWER.

None as **500** can be

A FAN OF INNOVATION



The **Uconnect™ 7" HD touchscreen with "tablet effect"** and **HD display**, the cutting edge of infotainment: a wide range of functions, from **Uconnect™** services offered as standard, with hands-free system, Bluetooth® technology, and voice recognition. In addition, together with FM/AM radio, the driver can connect his multimedia devices via USB or using the 3.5 mm auxiliary jack or even stream music via Bluetooth® from a compatible smartphone, giving him many musical options.

The Uconnect™ system is now also available with Apple CarPlay, the key for smart, safe, user-friendly iPhone use at the wheel. Now, you can make calls, play your music, send and receive messages, get directions optimized for traffic conditions and much more, while staying focused on the road.

Android Auto™ gives you useful information organised on simple screens which only appear when necessary. The function offers access to Google Maps, with voice-guided navigation, real time traffic information and lane guidance and Google Play Music and many other music services. You can make and receive calls and send messages while keeping your hands on the wheel and your eyes on the road.

* Apple CarPlay is a trademark of Apple Inc. Use of the Apple CarPlay logo means that a vehicle user interface meets Apple performance standards. Apple is not responsible for the operation of this vehicle or its compliance with safety and regulatory standards. Please note that the use of this product with iPhone, iPod, or iPad may affect wireless performance.

** Android Auto, Google Play and Google Maps are trademarks of Google Inc.

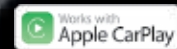

To enjoy Apple CarPlay* connect your iPhone to the specific USB port in your car.



To enjoy Android Auto™** connect your compatible smartphone to the specific USB port in your car.

To use Android Auto™ on your phone screen, you'll need an Android phone running 5.0 (Lollipop) or higher and the Android Auto app.



Is available in three different configurations:
Uconnect™ **HD** that includes radio tuner, steering wheel controls, **Bluetooth®** hands-free functionality.

UCONNECT™ RADIO

This is the gateway to the Uconnect™ world:
a simple but complete sound system thanks to the RDS tuner, the media player with **USB** and **AUX** inputs, and the steering wheel mounted audio controls.

UCONNECT™ 5" RADIO

Adds a large 5" touchscreen digital radio tuner in addition to steering wheel controls, hands-free **Bluetooth®** function and the Uconnect services™.

UCONNECT™ 7" HD

The Uconnect 7" system is equipped with a 7" high-resolution touch screen display with "smart gesture" functionality to have control at your fingertips.

Be always connect with new Uconnect Link:
Apple CarPlay integration & Android Auto compatibility available upon request.



INNOVATIVE TECHNOLOGIES BY

**MAGNETI
MARELLI**

Only with the **New 500**, at any time, you can finally have

EVERYTHING UNDER CONTROL.



TPMS



REAR PARK ASSIST

Only the New 500 offers you the chance, on request, to have an instrument panel with **7" TFT digital display** developed by Magneti Marelli. An instrument with information helpful for your driving, always in real time. Not only! It is all perfectly integrated with **Uconnect™** and **Uconnect™ 7"**, which let you also consult information on the Media functions, by telephone and connectivity, using the same screen.

Depending on the version of your **New 500**, the TFT display is available with two different basic graphics and it also changes appearance with the driving mode set: **Normal**, **Sport** or **Eco**. Even the **Rear Park Assist** display will be customised according to your New 500 model, while can control the tyre pressure with the **TPMS function** whenever you like.



REAR PARK ASSIST



AUDIO MEDIA



HANDS-FREE TELEPHONE

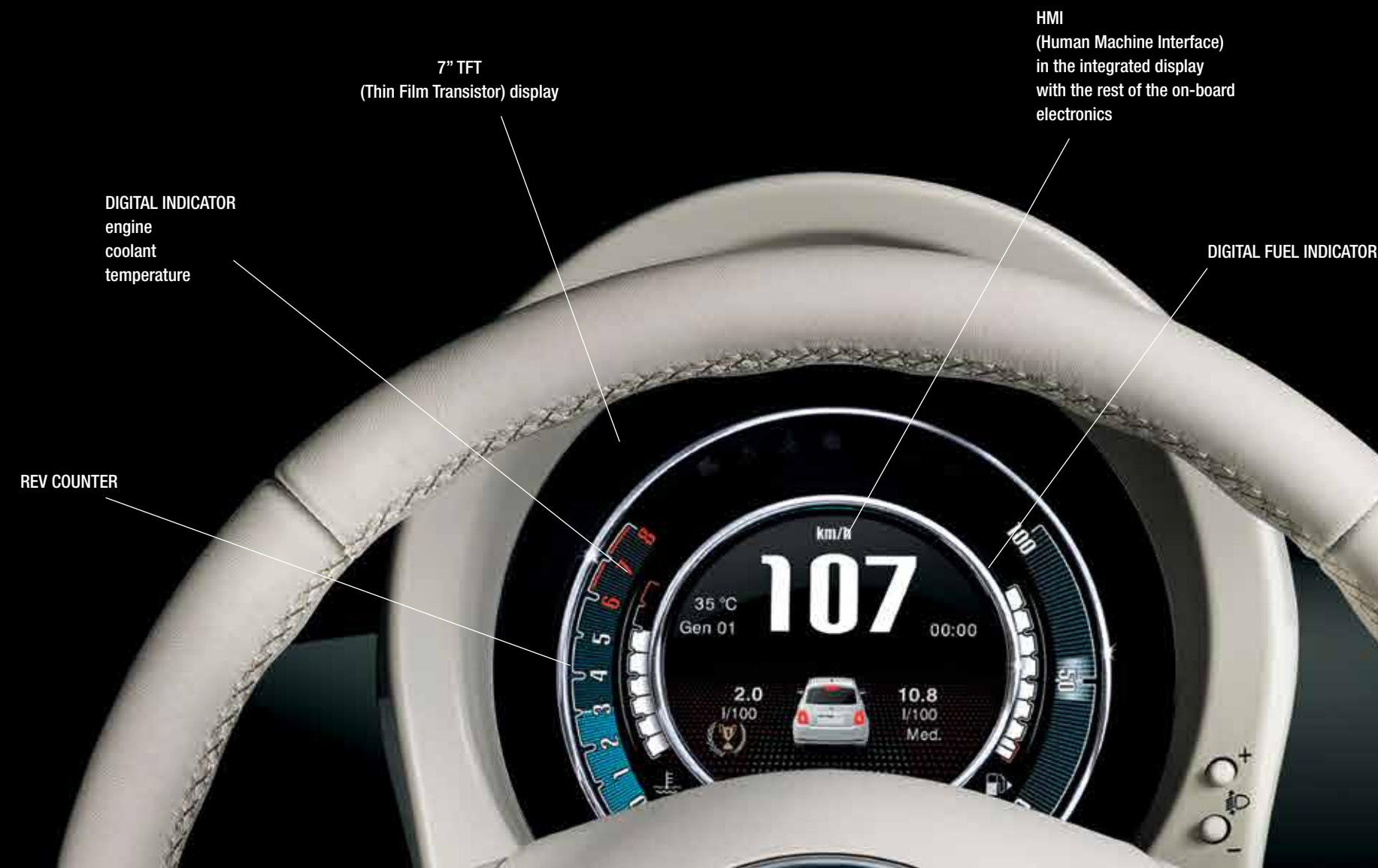

It is not hard to remain faithful to the original spirit, with increasingly more current style and performance. Not if you know how to

ALWAYS LOOK BEYOND.

WITH BI-XENON

In addition to the new line of front and rear optical groups developed in collaboration with Magneti Marelli, the **New 500** also delivers optional Xenon headlights, which expand your field of vision, increasing the light flux and diffusion. The results are incredible: your night vision increases by 200% compared to normal halogen headlights, giving you at least one extra second to spot obstacles and 28 metres advantage in terms of braking distance when travelling at 50 km/h. This means less stress, less eye fatigue and even notable energy saving: Xenon lights in fact consume less and last longer, almost three times longer than halogen lights.



ADVANTAGES

INCREASE SAFETY DUE TO:
INCREASED LIGHT FLUX
LIGHTING SIMILAR TO DAYLIGHT
IMPROVED
REACTION VISION FOR FASTER DRIVERS



HALOGEN HEADLIGHTS



XENON HEADLIGHTS

There is a secret to facing every moment of the day in comfort and in a good mood. The New 500 knows it:

CHANGE TO IMPRESS.

WITH DUALOGIC™

Created jointly by Fiat and Magneti Marelli, Dualogic™ the new generation robotised transmission allows you to choose the preferred driving style of the moment: relaxed and comfortable in automatic mode, ecofriendly and more attentive to fuel consumption with the ECO option, or agile and sporty using the sequential shifting with paddles on the steering wheel. When you want to use the manual gearbox, get ready to meet the bolder and sporty Dualogic™: the faster the engine revs, the faster and more aggressive gear changes become.

ADVANTAGES

PERFECT TRACTION AND GEAR SHIFTS UNDER ALL CONDITIONS

SAVE 60,000/200,000
GEAR SHIFTS A YEAR IN AUTOMATIC MODE

5% LOWER FUEL CONSUMPTION
(URBAN CYCLE) IN ECO MODE

LOWER EMISSIONS BY UP TO 88 G/KM
IN COMBINATION WITH THE TWINAIR ENGINE

INNOVATIVE TECHNOLOGIES BY

**MAGNETI
MARELLI**



I'M THE UNDISPUTED LEADER



OF THE ROAD,
NATURALLY.

* The chromed lower bumper is available with the Kit Lounge (Opt. 05F)



*The chromed lower bumper is standard on the Lounge model

0.9 TWINAIR TURBO 85 HP

- Displacement: 875 cm³
 - Fuel: Petrol
 - Emissions standard Euro 6
 - Anti-pollution device: Start&Stop
 - EC max power: 62.5 kW (85 HP) at 5500 rpm
 - Max EC torque: 145 Nm (14.8 kgm) at 1900 rpm
 - Top speed (km/h) 173
 - Acceleration (sec.): 0-100 km/h 11.0
 - Fuel consumption (L/100 Km)
- Combined consumption figure between 4.0L to 5.0L/100km*
Urban cycle: 4.6 • Extra-urban cycle: 3.4 • Combined cycle: 3.8
• CO₂ emissions (g/km): 90

0.9 TWINAIR TURBO 105 HP

- Displacement: 875 cm³
 - Fuel: Petrol
 - Emissions standard Euro 6
 - Anti-pollution device: Start&Stop
 - EC max power: 77 kW (105 HP) at 5500 rpm
 - Max EC torque: 145 Nm (14.8 kgm) at 2000 rpm
 - Top speed (km/h) 188
 - Acceleration (sec.): 0-100 km/h 10.0
 - Fuel consumption (L/100 Km)
- Combined consumption figure between 4.0L to 5.0L/100km*
Urban cycle: 5.5 • Extra-urban cycle: 3.5 • Combined cycle: 4.2
• CO₂ emissions (g/km): 99

*International combined fuel consumption tests indicate an average of between 4.0L - 5.0L/100km.
Altitude, weather and road conditions may alter the average consumption.

With the **New Fiat 500**

EVERY TRIP IS A SHOW.

500

Guaranteeing all the comfort you could possibly wish, the new seats are made with even more ergonomic materials and designed to facilitate passenger access to the rear seats. 7 standard airbags (front, side, window and driver's knee) ensure the only shivers allowed on-board come from the pleasure of driving.

IVORY AMBIENCE



BLACK AMBIENCE



LOUNGE - LOUNGE PACK



- Headrest and bezel available in fabric as standard
- Headrest and bezel are available in eco leather as optional - Lounge Pack 05F

- Headrest and bezel are available in eco leather as optional - Lounge Pack 05F

POP/POP STAR



BLACK LEATHER
GEAR KNOB
(optional)



IVORY LEATHER
GEAR KNOB
(optional)

LEATHER OPTIONAL*



*Leather seats are optional on Lounge models

500S LOVES DARING COMBINATIONS

When it comes to style, moderation is not its strong point. **New 500S** does not go unnoticed with its three new fabric interiors - with blue, yellow and white inserts - or two leather options perfectly matching all the body colours.



500S



AMBIENCE

LEATHER OPTIONAL



500S is equipped with a unique dashboard with Satin Graphite finish recalls the exterior details. The red 500 logo enhances the sporty character along with the specific design of the steering wheel with detail Satin Graphite.



INTERIOR TRIM COMBINATIONS



POP

CHEVRON FABRIC
Chevron two-tone fabric dark grey (seat-backrest) with sides and headrests in red fabric.
500 logo in red thermo-printed film.



POP

CHEVRON FABRIC
Chevron two-tone fabric dark grey (seat-backrest) with sides and headrests in grey fabric.
500 logo in grey thermo-printed film.



LOUNGE

PRINCE OF WALES FABRIC
Black-ivory check fabric with black sides and ivory piping. Headrest and bezel in fabric as standard / in eco leather as optional (Lounge Pack 05F). Contrasting embroidered 500 logo in ivory.



LOUNGE

PRINCE OF WALES FABRIC
Black-ivory check fabric with black sides and ivory piping. Headrest and bezel in fabric as standard / in eco leather as optional (Lounge Pack 05F). Contrasting embroidered 500 logo in black.



LOUNGE

PRINCE OF WALES FABRIC
Brown-ivory-coral check fabric with brown sides and coral piping. Headrest and bezel in eco leather (Lounge Pack 05F). Contrasting embroidered 500 logo in coral.



LOUNGE

PRINCE OF WALES FABRIC
Black-ivory-green check fabric with black sides and green piping. Headrest and bezel in eco leather (Lounge Pack 05F). Contrasting embroidered 500 logo in olive green.



500S

BLACK/LIGHT BLUE FABRIC
Seat and headrest in black eco leather and fabric on backrest with "sportball" pattern. Side inserts in light blue embossed technical fabric.
Two-colour embroidered 500 logo.



500S

BLACK/WHITE FABRIC
Seat and headrest in black eco leather and fabric on backrest with "sportball" pattern. Side inserts in white embossed technical fabric.
Two-colour embroidered 500 logo.



LOUNGE PACK (OPT. 88R) 500S

BLACK FRAU LEATHER
with ivory colour leather inserts. Leather headrest in Black colour. Contrasting ivory embroidered 500 logo.



LOUNGE PACK (OPT. 88R)

BURGUNDY FRAU LEATHER
with inserts in ivory leather. Headrest in burgundy. Contrasting ivory embroidered 500 logo.



LOUNGE PACK (OPT. 88R) 500S

BURGUNDY FRAU LEATHER
with inserts in light-blue leather. Headrest in bordeaux. Contrasting light-blue embroidered 500 logo.



LOUNGE PACK (OPT. 88R)

TOBACCO FRAU LEATHER
with ivory colour leather inserts. Tobacco leather headrest. Contrasting ivory embroidered 500 logo.

ALLOY WHEELS - WHEEL COVERS



73Z - 15" ALLOY WHEELS
Glossy silver



6Y8 - 15" S ALLOY WHEELS
Satin graphite finish



7HP - 16" S ALLOY WHEELS
Matt black painted with diamond finish



5EQ - 16" ALLOY WHEELS
Opaque diamond finish anthracite



14" STEEL WHEELS

PAINT FINISHES
PASTEL



111
PASSADOBLE RED



166
SMOOTH MINT GREEN



268
BASSANOVA WHITE



552
CORAL RED



735
TECH HOUSE GREY

ROOF COLOURS
CONVERTIBLE



RED SOFT-TOP



BLACK SOFT-TOP

500s convertible is available with black roof only

BODY COLOURS
METALLIC



372
COLOSSEO GREY



425 - AVAILABLE ON 500S VERSION ONLY
BLUE ITALIA



866 - NOT AVAILABLE ON CONVERTIBLE VERSION
BORDEAUX METALLIC



687
EPIC BLUE



695
POMPEI GREY



876
CROSSOVER BLACK

BODY COLOURS
TRICOAT



227
ICE WHITE

MATT



149 - AVAILABLE ON 500S VERSION ONLY
ALPI GREEN

BODY COLOURED DASHBOARD





DETAILS ARE NEVER



JUST DETAILS.



Thanks to Mopar accessories

NO 500 IS QUITE LIKE ANY OTHER.

ORIGINAL ACCESSORIES

Body stickers, key covers, side badges, make-up holders, rims: those eager to express their creative flair have everything they need to put their own stamp on a veritable design object, making it a real one-off.



SPORT PACK

Black: Black Sport Strip stickers, black mirror covers and Sport key cover kit

White: White Sport Strip stickers, white mirror covers and Sport key cover kit

Red: Red Sport Strip stickers, red mirror covers and Sport key cover kit

The sport side band is also available individually in white, red and black



CHEQUERED ROOF

Available in white, red and black



ONE-TONE BLACK BAND WITH 500 LOGO



ITALIA 500 STRIP

INTERIOR TRIM PACK

Making the New 500 even more irresistible and colourful is really simple, thanks to four new wrapping packs each containing a different trim for the roof and mirror caps.



GREEN MILITARY PACK

Available only for Tin Top models



MATT TITANIUM GREY

Available only for Tin Top models

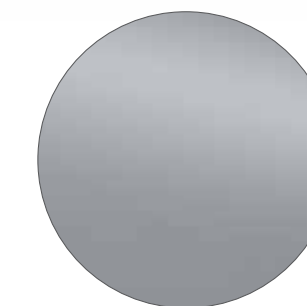

MATT SILVER GREY

Available only for Tin Top models

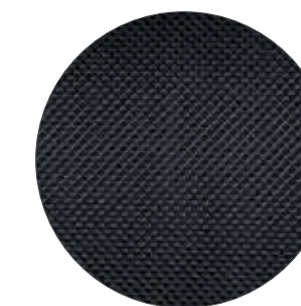

BLACK MICRO CARBON PACK

Available only for Tin Top models

BADGE

* To be combined with the protective strips



Italy*



Black 500 also available in red*



Black Sport also available in red*



Red stitching*



Red checks also available in black*

KEY COVERS



Swarovski snake



Swarovski with 500 logo



Swarovski flowers



White and blue Italy kit



White and green military



Red coral and chevron pattern kit



Italian flag badge on wing

INTERIORS

The New 500 dashboard can be customised with new trim available in two colours: one more chic with black micro carbon and a new cooler option in green military.



CHROME-PLATED BONNET LINE

REAR SPOILER

ITALIAN FLAG BADGE ON WING

COAT HANGER FOR FRONT HEAD RESTRAINT

2 COLOURS: IVORY AND BLACK
SPORTS ALUMINIUM PEDAL COVERS AND FOOTREST

STEEL KICK PLATE

CARPET MATS



COLOURS/INTERIOR TRIM COMBINATIONS



VERSION	POP/POP STAR				OPT. 05F (KIT LOUNGE)			
	241	273	243	359	302	301	374	605
FABRIC	Grey-black Chevron pattern fabric				Prince of Wales check pattern fabric with black eco leather upper-part	Prince of Wales check pattern fabric with black eco leather upper-part	Prince of Wales check pattern fabric with ivory eco leather upper-part	Prince of Wales check pattern fabric with ivory eco leather upper-part
KNOB	GLOSSY BLACK							
LEATHER KNOB (OPT 4VU)	-	-	-	-	BLACK	BLACK	IVORY	IVORY
STEERING WHEEL	IVORY 6 BUTTONS (FOAMED)	BLACK 6 BUTTONS (FOAMED)	IVORY 6 BUTTONS (FOAMED)	BLACK 6 BUTTONS (FOAMED)	BLACK 8 BUTTONS (LEATHER)	BLACK 8 BUTTONS (LEATHER)	IVORY 8 BUTTONS (LEATHER)	IVORY 8 BUTTONS (LEATHER)
SEAT COLOUR	GREY/BLACK		GREY/BLACK		BLACK/GREY/GREEN	BLACK/LIGHT GREY/IVORY	BLACK/LIGHT GREY/IVORY	IVORY/BROWN/CORAL
LOGO 500 COLOUR / PIPING	RED		LIGHT GREY		GREEN	IVORY	BLACK/IVORY	CORAL
SIDE COLOUR / DOOR PANEL COLOUR /HEAD RESTRAINTS COLOUR	RED		LIGHT GREY		BLACK	BLACK	BLACK (IVORY HEAD RESTRAINTS)	BROWN (IVORY HEAD RESTRAINTS)
AMBIENCE COLOUR	IVORY	BLACK	IVORY	BLACK	BLACK	BLACK	IVORY	IVORY
CEILING COLOUR	IVORY							
PASTEL								
268 Bassanova White	•	•	•	•	•	•	•	•
552 Coral Red			•	•		•	•	•
735 Tech House Grey	•	•	•	•	•	•	•	•
166 Smooth Mint Green			•	•		•	•	
111 Passaboble Red	•	•	•	•		•	•	
METALLIC								
876 Crossover Black	•	•	•	•	•	•	•	•
866 Bordeaux Metallic			•	•		•	•	
425 Blue Italia						•	•	
687 Epic Blue	•	•	•	•	•	•	•	•
TRICOAT								
227 Ice White	•	•	•	•	•	•	•	•
MATT								
149 Alpi Green								

LOUNGE - LEATHER INTERIOR (opt. 211) / (Lounge Pack 88R)				SPORT		SPORT LEATHER INTERIOR (opt. 211)	
687	688	861	461	724	725	598	508
Frau leather				Sport fabric	Sport fabric	Frau leather	Frau leather
GLOSSY BLACK							
BLACK	BLACK	IVORY	IVORY	BLACK	BLACK	BLACK	BLACK
BLACK 8 BUTTONS (LEATHER)	BLACK 8 BUTTONS (LEATHER)	IVORY 8 BUTTONS (LEATHER)	IVORY 8 BUTTONS (LEATHER)	BLACK SPORT LATHER 8 buttons	BLACK SPORT LATHER 8 buttons	BLACK SPORT LATHER 8 buttons	BLACK SPORT LATHER 8 buttons
BLACK / IVORY	BURGUNDY / LIGHT BLUE	BURGUNDY / IVORY	NEW TABACCO / IVORY	BLACK / WHITE	BLACK / BLUE	BLACK / IVORY	BORDEAUX / LIGHT BLUE
IVORY	LIGHT BLUE	IVORY	IVORY	GREY / WHITE	GREY / BLUE	IVORY	LIGHT BLUE
BLACK	BORDEAUX	BORDEAUX	NEW TABACCO	BLACK / WHITE	BLACK / BLUE	BLACK	BLACK
BLACK	BLACK	IVORY	IVORY	BLACK	BLACK	BLACK	BLACK
IVORY				BLACK	BLACK	BLACK	BLACK
•	•	•	•	•	•	•	•
•			•				
•	•	•	•	•	•	•	•
•			•				
•			•	•		•	
•	•	•	•	•	•	•	•
•	•	•	•	•		•	•
				•	•	•	
•			•	•			
•	•	•	•	•	•	•	•
				•		•	

COLOURS/INTERIOR TRIM COMBINATIONS



ROOF COLOUR	RED				
VERSION	LOUNGE				
	310		121	681	983
FABRIC	Prince of Wales check pattern fabric with black eco leather upper-part		Prince of Wales check pattern fabric with black eco leather upper-part	Prince of Wales check pattern fabric with ivory eco leather upper-part	Prince of Wales check pattern fabric with ivory eco leather upper-part
KNOB					
LEATHER KNOB (OPT 4VU)	BLACK		BLACK	IVORY	IVORY
STEERING WHEEL	BLACK 8 BUTTONS (LEATHER)		BLACK 8 BUTTONS (LEATHER)	IVORY 8 BUTTONS (LEATHER)	IVORY 8 BUTTONS (LEATHER)
SEAT COLOUR	NR/GREY+DEEP GREEN		BLACK/LIGHT GREY/IVORY	BLACK/LIGHT GREY/IVORY	IVORY/BROWN/CORAL
LOGO 500 COLOUR / PIPING	DEEP GREEN		IVORY	BLACK/IVORY	CORAL
SIDE COLOUR / DOOR PANEL COLOUR / HEAD RESTRAINTS COLOUR	BLACK		BLACK	BLACK (IVORY HEAD RESTRAINTS)	BROWN (IVORY HEAD RESTRAINTS)
AMBIENCE COLOUR	BLACK		BLACK	IVORY	IVORY
CEILING COLOUR					
PASTEL					
268 Bassanova White			•	•	
552 Coral Red					
735 Tech House Grey			•	•	
166 Smooth Mint Green					
111 Passadoble Red					
METALLIC					
876 Crossover Black			•	•	
425 Blue Italia			△	△	
687 Epic Blue					
TRICOAT					
227 Ice White			•	•	

△ Lineaccessori

RED			
LOUNGE - optional leather (code 211+728)			
458	080	093	505
Frau leather			
BLACK	BLACK	IVORY	IVORY
BLACK 8 BUTTONS (LEATHER)	BLACK 8 BUTTONS (LEATHER)	IVORY 8 BUTTONS (LEATHER)	IVORY 8 BUTTONS (LEATHER)
BLACK / IVORY	BURGUNDY / LIGHT BLUE	BURGUNDY / IVORY	NEW TABACCO / IVORY
IVORY	LIGHT BLUE	IVORY	IVORY
BLACK	BORDEAUX	BORDEAUX	NEW TABACCO
BLACK	BLACK	IVORY	IVORY
•	•	•	•
•	•	•	•
•			•
•	•	•	•

COLOURS/INTERIOR TRIM COMBINATIONS



ROOF COLOUR	BLACK								
VERSION	OPT. 05F (KIT LOUNGE)					LOUNGE - LEATHER INTERIOR (opt. 211) / (Lounge Pack 88R)			
	376	127	682	984		459	083	096	577
FABRIC	Prince of Wales check pattern fabric with black eco leather upper-part	Prince of Wales check pattern fabric with black eco leather upper-part	Prince of Wales check pattern fabric with ivory eco leather upper-part	Prince of Wales check pattern fabric with ivory eco leather upper-part		FRAU LEATHER			
KNOB									
LEATHER KNOB (OPT 4VU)	BLACK	BLACK	IVORY	IVORY		BLACK	BLACK	IVORY	IVORY
STEERING WHEEL	BLACK 8 BUTTONS (LEATHER)	BLACK 8 BUTTONS (LEATHER)	IVORY 8 BUTTONS (LEATHER)	IVORY 8 BUTTONS (LEATHER)		BLACK 8 BUTTONS (LEATHER)	BLACK 8 BUTTONS (LEATHER)	IVORY 8 BUTTONS (LEATHER)	IVORY 8 BUTTONS (LEATHER)
SEAT COLOUR	BLACK /GREY / GREEN	BLACK / LIGHT GREY / IVORY	BLACK / LIGHT GREY / IVORY	IVORY/BROWN/ CORAL		BLACK / IVORY	BURGUNDY / LIGHT BLUE	BURGUNDY / IVORY	NEW TABACCO / IVORY
LOGO 500 COLOUR / PIPING	GREEN	IVORY	BLACK/IVORY	CORAL		IVORY	LIGHT BLUE	IVORY	IVORY
SIDE COLOUR / DOOR PANEL COLOUR / HEAD RESTRAINTS COLOUR	BLACK	BLACK	BLACK (IVORY HEAD RESTRAINTS)	BROWN (IVORY HEAD RESTRAINTS)		BLACK	BORDEAUX	BORDEAUX	NEW TABACCO
AMBIENCE COLOUR	BLACK	BLACK	IVORY	IVORY		BLACK	BLACK	IVORY	IVORY
CEILING COLOUR									
PASTEL									
268 Bassanova White	•	•	•	•		•	•	•	•
552 Coral Red		•	•	•		•			•
735 Tech House Grey	•	•	•	•		•	•	•	•
166 Smooth Mint Green		•	•			•			•
111 Passadoble Red		•	•			•			•
METALLIC									
876 Crossover Black	•	•	•	•		•	•	•	•
425 Blue Italia		•	•						
687 Epic Blue	•	•	•	•		•			•
TRICOAT									
227 Ice White	•	•	•	•		•	•	•	•

BLACK			
SPORT		SPORT LEATHER INTERIOR (opt. 211)	
802	685	451	440
SPORT FABRIC		FRAU LEATHER	

BLACK	BLACK	BLACK	BLACK
BLACK SPORT LATHER 8 buttons	BLACK SPORT LATHER 8 buttons	BLACK SPORT LATHER 8 buttons	BLACK SPORT LATHER 8 buttons
BLACK / BLUE	BLACK / WHITE	BORDEAUX / LIGHT BLUE	BLACK / IVORY
GREY / BLUE	GREY / WHITE	LIGHT BLUE	IVORY
BLACK / BLUE	BLACK / WHITE	BLACK	BLACK
BLACK	BLACK	BLACK	BLACK
BLACK	BLACK	BLACK	BLACK
•	•	•	•
•	•	•	•
	•		•
•	•	•	•
•	•		•
•	•	•	•

TECHNICAL SPECIFICATIONS



	TwinAir 0.9 85 HP Turbo Start&Stop		TwinAir 0.9 105 HP Turbo Start&Stop	
Engine	Hatchback - Convertible		Hatchback - Convertible	
No. of cylinders, arrangement	2, straight, diagonal front		2, straight, diagonal front	
Bore x stroke (mm)	80.5 x 86		80.5 x 86	
Displacement (cm³)	875		875	
Fuel	Petrol		Petrol	
Emissions standard	Euro 6		Euro 6	
Compression ratio	10.0:1		10.0:1	
EC max. power: kW (HP) at rpm	62.5 (85) 5500		77 (105) 5500	
EC max. torque: Nm (kgm) at rpm	145 (14.8) 1900		145 (14.8) 2000	
Fuel system	Multipoint electronic injection with sequential timed injection, knock control and variable intake valve actuation		Multipoint electronic injection with sequential timed injection, knock control and variable intake valve actuation	
Ignition	controlled		controlled	
Transmission				
Drive	front-wheel		front-wheel	
Clutch	hydraulic		hydraulic	
Gearbox, No. of gears	5 + reverse		6 + reverse	
Steering				
Type	Rack and pinion with electric Dualdrive™ electric power steering		Rack and pinion with electric Dualdrive™ electric power steering	
Turning circle (m)	9.3		9.3	
Brakes				
	ABS with EBD and ESC		ABS with EBD and ESC	
Front: Ø (mm)	disc Ø 257 mm		self-ventilating disc Ø 257 mm	
Rear: Ø (mm)	drum Ø 180 mm		disc Ø 240 mm	
Suspension				
Front:	Independent-wheel, MacPherson-type with lower transversal wishbones secured to an auxiliary crossmember, anti-roll bar connected to the shock absorber		Independent-wheel, MacPherson-type with lower transversal wishbones secured to an auxiliary crossmember, anti-roll bar connected to the shock absorber	
Rear:	Inter-connected wheel through torsion beam and anti-roll bar		Inter-connected wheel through torsion beam and anti-roll bar	
Wheels				
POP	175/65 R 14			
POP STAR	185/55 R 15			
LOUNGE	195/45 R 16			
SPORT			185/55 R 15	

	TwinAir 0.9 85 HP Turbo Start&Stop		TwinAir 0.9 105 HP Turbo Start&Stop	
Size	Hatchback - Convertible		Hatchback - Convertible	
Length (mm)	3571		3612	
Width (mm) with / without mirrors	1627 / 1893		1627 / 1893	
Height in running order (mm)	1488		1506	
Wheelbase (mm)	2300		2300	
Front track (mm)	1413		1413	
Rear track (mm)	1407		1407	
Capacity of luggage compartment (dm³)	185		185	
Weights				
DIN kerb weight (kg)	930 / 970*		940 / 980*	
Towable weight, non-braked (kg)	400		400	
Braked (kg)	800		800	
Capacities				
Fuel tank capacity (litres)	35		35	
12 V battery				
Capacity (Ah)	63		63	
Performance				
Top speed (km/h)	173		188	
Acceleration (sec.): 0-100 km/h	11		10.0	
Fuel consumption (L/100 Km) Directive 2004/3/EC				
Urban cycle	4.6/4.3**		5.5	
Extra-urban cycle	3.4/3.5**		3.5	
Combined cycle	3.8/3.8**		4.2	
CO₂ exhaust emissions (g/km)	90/88**		99	

* Cabrio ** Values refer to vehicles equipped with Dualogic™ transmission

STANDARD AND OPTIONAL EQUIPMENT



		500				500C	
		POP	POP STAR	LOUNGE	S	LOUNGE	S
LINE AND STYLE							
Bumpers in body colour		■	■	■	■	■	■
Chrome-plated exterior door handles		■	■	■	■	■	■
Steering wheel mounted audio controls (6 buttons)	4WE	■		-	-	-	-
Leather steering wheel with audio controls (8 buttons)	318	○	■	■	■	■	■
Electrically adjustable painted door mirrors with defrosting and external temperature sensor	041	○	■	■	■	○	■
Dark tinted rear windows	070	-	-	○	■	○	○
Leather interior (includes opt. 195)	211	-	-	○	○	○	○
Leather gear knob**	4VU	-	-	○	○	○	○
Body coloured side rubbing strips with Fiat 500 logo	4M5	○	-	○	-	○	-
Metallic paint		○	○	○	○	○	○
Tricoat paint		○	○	○	○	○	○
Sport Red Pack: contains red Sport Stripe sticker, red mirror covers and Sport Key cover kit	8D6	△		△	-	△	-
Sport White Pack: contains white Sport Stripe sticker, white mirror covers and Sport Key cover kit	8D7	△		△	-	△	-
Sport Black Pack: contains black Sport Stripe sticker, black mirror covers and Sport Key cover kit	8D8	△		△	-	△	-
Micro Carbon Black Pack: comprised of mirror covers and roof	8D9	△		△	-	-	-
Military Green Pack: comprised of mirror covers and roof	8DF	△		△	-	-	-
Matt titanium Pack: comprised of mirror covers and roof	8DB	△		△	-	-	-
Matt Silver Pack: comprised of mirror covers and roof	8DA	△		△	-	-	-

■ standard ○ optional - not available △ Lineaccessori * not available for Opera Bordeaux (866) and Three-layer White (227/B) ** the leather gear knob will always match the colour of the steering wheel

CUSTOMISATION

		500				500C	
		POP	POP STAR	LOUNGE	S	LOUNGE	S
Chrome trim on bonnet	4BJ	-	○	○	-	○	-
14" grey hub caps	6YL	-	-	-	-	-	-
15" alloy wheels glossy silver	73Z	-	■	-	-	-	-
16" alloy wheels opaque diamond finish anthracite	5EQ	-	-	■	-	■	-
15" alloy wheels satin graphite finish	6Y8	-		-	■	-	■
16" alloy wheels matt black painted with diamond finish	7HP	-		-	○	-	○

■ standard ○ optional - not available △ Lineaccessori

STANDARD AND OPTIONAL EQUIPMENT



	500					500C	
	POP	POP STAR	LOUNGE	S		LOUNGE	S
CUSTOMISATION							
15" alloy wheels with 18 spokes and 185/55 tyres (not compatible with snow chains)	△	△	△	△		△	△
15" alloy wheels with 9-dual-spokes and 185/55 tyres (not compatible with snow chains)	△	△	△	△		△	△
15", 5-spoke two-tone diamond finish Sport alloy wheels with 185/55* tyres (not compatible with snow chains)	△	△	△	△		△	△
15", 5-spoke Sport alloy wheels and 185/55 tyres (not compatible with snow chains)	△	△	△	△		△	△
16" alloy wheels with 8 spokes and 195/45 (not compatible with snow chains)	△	△	△	△		△	△
16", 5-spoke diamond finish Sport alloy wheels with 195/45* tyres (not compatible with snow chains)	△	△	△	△		△	△
16", 7-spoke diamond finish Sport alloy wheels with 195/45* tyres (not compatible with snow chains)	△	△	△	△		△	△
16" alloy wheels with 17 spokes and 195/45 tyres (not compatible with snow chains)	△	△	△	△		△	△
16", 20-spoke diamond finish grey/black alloy wheels and 195/45 tyres (not compatible with snow chains)	△	△	△	△		△	△
16", 20-spoke diamond finish white alloy wheels and 195/45 tyres (not compatible with snow chains)	△	△	△	△		△	△
Chrome-plated bonnet line	△	△	△	△		△	△
Red Sport Strip stickers	△	△	△	△		△	△
White Sport Strip stickers	△	△	△	△		△	△
Black Sport Strip stickers	△	△	△	△		△	△
Black chequered roof sticker	△	△	△	△		-	-
White chequered roof sticker	△	△	△	△		-	-
Red chequered roof sticker	△	△	△	△		-	-
Italia Side Strip stickers	△	△	△	△		△	-
Italia 500 Strip stickers	△	△	△	△		-	-
500 Italia Strip stickers (for glass roof)	△	△	△	△		-	-
One-tone Black Strip sticker with 500 logo	△	△	△	△		-	-
Rear spoiler on tailgate	△	△	△	△		-	-

■ standard ○ optional - not available △ Lineaccessori

	500					500C	
	POP	POP STAR	LOUNGE	S		LOUNGE	S
CUSTOMISATION							
Protective strips (for customised badges)	△	△	△	△		△	△
500 Italia badge for protective strips	△	△	△	△		△	△
Black chequered badge for protective strips	△	△	△	△		△	△
Red chequered badge for protective strips	△	△	△	△		△	△
Black sport badge on white background for protective strips	△	△	△	△		△	△
Red sport badge on white background for protective strips	△	△	△	△		△	△
500 black badge for protective strips	△	△	△	△		△	△
Italian flag badge on wing	△	△	△	△		△	△
500 red badge for protective strips	△	△	△	△		△	△
500 red line badge on black background for protective strips	△	△	△	△		△	△
Green military dashboard trim (for left hand drive)	△	△	△	△		△	△
Micro carbon black dashboard trim (for left hand drive)	△	△	△	△		△	△
Sport key cover kit	△	△	△	△		△	△
Italy key cover kit	△	△	△	△		△	△
White and blue - white and green key cover kit	△	△	△	△		△	△
Coral red key cover kit and chevron fantasy	△	△	△	△		△	△
Swarovski Flowers key cover	△	△	△	△		△	△
Swarovski Snake key cover	△	△	△	△		△	△
Swarovski key cover with 500 logo	△	△	△	△		△	△
Chrome mirror fairings	△	△	△	△		△	△
Red mirror covers	△	△	△	△		△	△
Black mirror covers	△	△	△	△		△	△
White mirror covers	△	△	△	△		△	△
Side front deflectors	△	△	△	△		△	△
Car cover with the image of the Fiat 500 first series	△	△	△	△		△	△
Steel kick plate	△	△	△	△		△	△

■ standard ○ optional - not available △ Lineaccessori

STANDARD AND OPTIONAL EQUIPMENT



	500				500C	
	POP	POP STAR	LOUNGE	S	LOUNGE	S
CUSTOMISATION						
Sports aluminium pedal covers and footrest	△	△	△	△	△	△
Black coat hanger for front head restraint	△	△	△	△	△	△
Ivory coat hanger for front head restraint	△	△	△	△	△	△
Rubber protective mats	△	△	△	△	△	△
Protective mats with black border ivory graphics	△	△	△	△	△	△
Protective mats with ivory border ivory graphics	△	△	△	△	△	△
Protective mats with black border black graphics	△	△	△	△	△	△
Tyre valve caps with Fiat logo	△	△	△	△	△	△
Chrome rear plate holder	△	△	△	△	△	△
Windstop for 500C	-	-	-	-	△	△
Black fabric make-up holder	△	△	△	△	△	△
Ivory leather make-up holder with silver trinket	△	△	△	△	△	△
COMFORT						
Fiat CODE (electronic anti-theft device)	■	■	■	■	■	■
Heat-reflecting windows	■	■	■	■	■	■
Instrument panel with rev counter	■	■	■	■	■	■
7" TFT instrument cluster46F	-	-	○	■	○	■
Height-adjustable front head restraints	■	■	■	■	■	■
Height-adjustable steering wheel	■	■	■	■	■	■
Dualdrive™ electric power steering	■	■	■	■	■	■
Start&Stop5DE	■	■	■	■	■	■
Electric windows and central locking	■	■	■	■	■	■

■ standard ○ optional - not available △ Lineaccessori

		500				500C	
		POP	POP STAR	LOUNGE	S	LOUNGE	S
COMFORT							
Follow-Me-Home light device		■	■	■	■	■	■
Fuel filler cap with key352		■	■	■	■	■	■
Rear window wiper/washer and heated rear window		■	■	■	■	-	-
Trip computer		■	■	■	■	■	■
Door opening/closing remote control with customisable cover		■	■	■	■	■	-
Space saver spare wheel803		■	■	■	■	■	■
Luggage compartment lighting		-	-	■	■	■	■
Sun visor with courtesy light and mirror		-	-	■	■	-	-
Air conditioning025		■	■	■	■	■	■
Automatic climate control140		-	-	■	■	■	■
Dualogic™ semi automatic transmission (not available with 0.9 TwinAir 105 hp)407		○	○	○	--	○	-
Steering wheel with Selespeed Pads - 6 buttons6BM		○	-	-	-	-	-
Dualogic™ controls on steering wheel (not available on 0.9 TwinAir 105 hp)5BH		○	○	○	-	○	-
Bi-xenon headlights with retractable headlight washer230		-	-	○	○	○	○
Electrochromatic rear view mirror410		-	-	■	■	■	■
Fixed glass roof with sunblind59E		○	○	■	○	-	-
Electric sunroof400		-	-	○	○	-	-
Height adjustable driver's seat626		-	-	■	○	■	○
Seat-back pockets339		-	-	○	○	○	○
50/50 split folding rear seat with height adjustable head restraints195		■	■	■	■	■	■

■ standard ○ optional - not available △ Lineaccessori

STANDARD AND OPTIONAL EQUIPMENT



		500				500C	
		POP	POP STAR	LOUNGE	S	LOUNGE	S
COMFORT							
Front seats with memory		■	■	■	■	■	■
Rear parking sensors	508	-	■	■	■	■	■
Volumetric alarm		△	△	△	△	-	-
Aluminium bars on tailgate		△	△	△	△	-	-
Ski rack for tailgate bars		△	△	△	△	-	-
Snowboard rack for tailgate bars		△	△	△	△	-	-
Carry all net for luggage compartment		△	△	△	△	△	△
Luggage compartments organizer		△	△	△	△	△	△
Retractable tow bar		△	△	△	△	△	△
Cable for retractable tow bar 50901575		△	△	△	△	△	△
Car care		△	△	△	△	△	△
SAFETY							
Driver and passenger airbag with Dual stage system		■	■	■	■	■	■
Side airbags		■	■	■	■	■	■
Window airbags		■	■	■	■	■	■
Driver's knee airbag		■	■	■	■	■	■
Bodywork with high-resistance steel elements (Dualphase)		■	■	■	■	■	■
FPS (Fire Prevention System)		■	■	■	■	■	■
Hazard light automatic activation during emergency braking		■	■	■	■	■	■
Headlight alignment corrector		■	■	■	■	■	■
Front seat belts with pretensioners, load limiter and fastening sensor		■	■	■	■	■	■
Front and rear seats with anti-submarining crossmember		■	■	■	■	■	■

■ standard ○ optional - not available △ Lineaccessori

		500				500C	
		POP	POP STAR	LOUNGE	S	LOUNGE	S
SAFETY							
Isofix attachment points for child safety seat on rear seat		■	■	■	■	■	■
DRLs with LED technology		■	■	■	■	■	■
ESC (Electronic Stability Control) & MSR, ASR & Hillholder	392	■	■	■	■	■	■
TPMS	5YB	■	■	■	■	■	■
Fog lights	097	○	■	■	■	■	■
Anti-theft wheel bolts		△	△	△	△	△	△
Spare bulb kit		△	△	△	△	△	△
Safety kit		△	△	△	△	△	△
AUDIO							
Uconnect™ Radio with USB and Aux-in	6ZE	■	-	--	-	-	-
Uconnect™ 5" Radio LIVE (Dual Tuner/USB/AUX/Bluetooth®)	7HZ	-	■	-	-	-	-
Uconnect™ 7" HD LIVE (AM/FM Dual Turner, Bluetooth®, USB, Audio Streaming)	7Q8	-	-	■	■	■	■
Uconnect LINK* Apple Car Play Integration - Android Auto™ compatible	8EW	-	-	■	■	■	■

■ standard ○ optional - not available △ Lineaccessori

* with Uconnect only



MAINTAIN YOUR VEHICLE IN TIP TOP CONDITION, ALWAYS.

Mopar® Vehicle Protection knows that your vehicle needs different care at different points in its life, that is why we have designed a range of services tailored for you and your car by Mopar®, the Official Service Partner of FCA.

Our aim is to ensure that your driving experience will always be pleasant and reassuring, with your car in perfect shape just like the first day you bought it.

SELECT SERVICES THAT SUIT YOUR DRIVING NEEDS BEST.

CIAO FIAT



CIAO FIAT CUSTOMER SERVICE

0800 FIATSA (0800 342 872)

Helpdesk: Weekdays 06:00 to 18:00

Roadside Assistance: 24/7

EXTENDED WARRANTY PLANS

PLATINUM CARE

A plan designed to offer you an easy way to manage your vehicle's wear and tear requirements, ensuring that your vehicle never misses a vital service interval as well as guaranteeing that you get the maximum long-term use out of your vehicle.

POWERTRAIN CARE

A plan designed to cover the mechanical parts of the driveline and transmission.

EXTENDED MAINTENANCE PLANS

The simplest way to cover your scheduled maintenance over time and guarantee complete peace of mind.

PREMIUM CARE

The most complete service ever, all rolled into one easy plan. Receive the maximum life out of your vehicle with the plan that gives you the best level of scheduled maintenance.

ENGINE CARE

A plan designed to cover the mechanical parts of the engine.

ELECTRICAL CARE

A plan designed to cover the electrical components of your vehicle.

OIL CARE

Fix the price of your regular servicing. A service plan designed to be a simple way to budget for your vehicle's servicing requirements, ensuring your vehicle never misses a vital service interval and guarantees you maximum life out of your vehicle.

To continue with the validity of the warranty throughout the term you will need to maintain the vehicle in accordance with the manufacturers' scheduled servicing.

Mopar® Vehicle Protection extended warranties and maintenance plans have been designed to ensure that your driving experience will be always pleasant. Ask your dealer about our dedicated tailored services where all operations are performed by qualified technicians.

For further information or complete news relating to our product line go to <https://www.fiat.co.za/mopar>